

COLIBRI ONE/TWO DRO

Opening sensors for automatic doors

Other use of the device is outside the permitted purpose and can not be guaranteed by the manufacturer.

The manufacturer cannot be held responsible for incorrect installations or inappropriate adjustments of the sensor.

COLIBRI ONE DRO : Unidirectional detection

COLIBRI TWO DRO : Bidirectional detection

DESCRIPTION

1. main connector
2. potentiometer for field size adjustment
3. LED
4. radar antenna (wide field)
5. cover

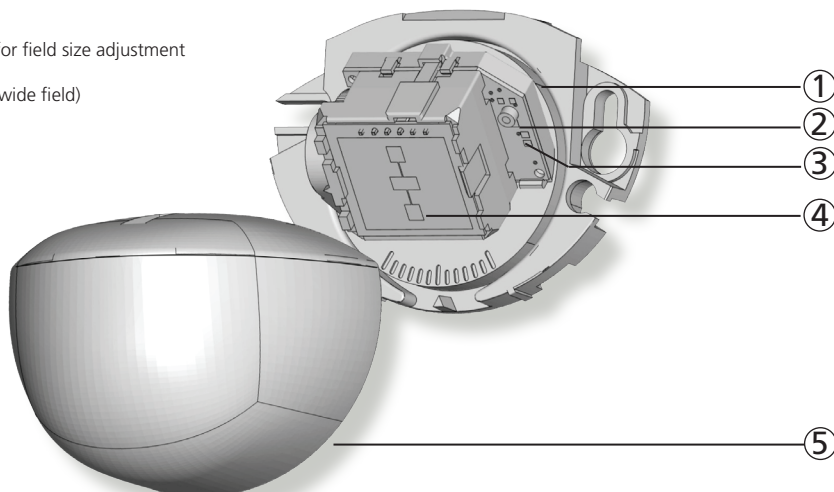

TECHNICAL SPECIFICATIONS

Technology:	microwave doppler radar
Transmitter frequency:	24.150 GHz
Transmitter radiated power:	< 20 dBm EIRP
Transmitter power density:	< 5 mW/cm ²
Detection mode:	motion
Min. detection speed:	5 cm/s (measured in sensor axis)
Supply voltage:	12 V to 24 V DC +30% / -10% (The Equipment must be powered by a SELV limited power source ensuring double insulation between primary voltages and the Equipment supply. The supply current should be limited to 1.5 A.)
Mains frequency:	50 to 60 Hz
Max. power consumption:	< 2 W
Output:	
Max. contact current:	250 mA
Max. contact voltage:	50 V DC/V AC
Mounting height:	from 1.8 m to 3 m
Degree of protection:	IP54
Temperature range:	from -20 °C to + 55 °C
Dimensions:	80 mm (W) x 60 mm (H) x 50 mm (D)
Tilt angles:	0° to 90° vertical; -30° to +30° lateral
Material:	ABS & polycarbonate
Weight:	70 g
Cable length:	2.5 m

APPLICATIONS

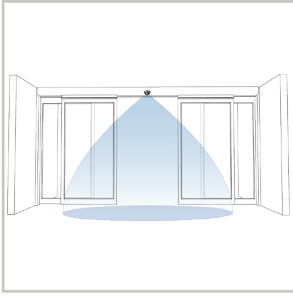

Wall mounting above sliding or revolving doors

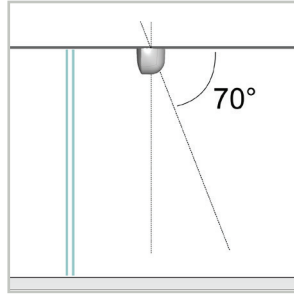

Ceiling mounting in front of sliding, revolving or swing doors (outside of the door motion range)

OPENING THE SENSOR

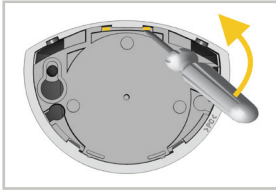

Before fixing

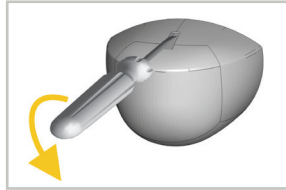

After fixing

TIPS

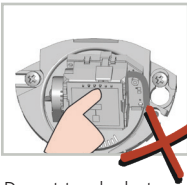

Do not touch electrical parts.

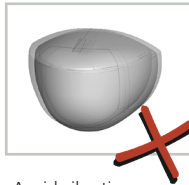

Avoid vibrations.

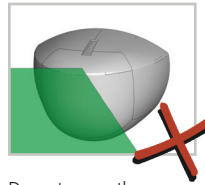

Do not cover the sensor.

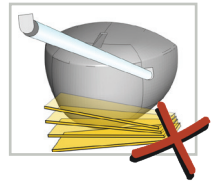



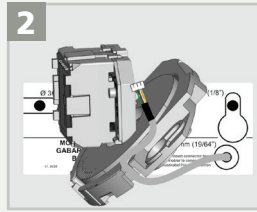
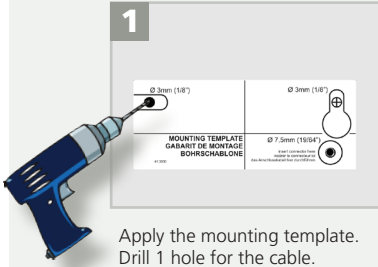

Avoid proximity to neon lamps or moving objects.

1 MOUNTING & WIRING

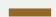

Connect the cable and insert it through the hole.
Connect the wires as follows:

-  BROWN - POWER SUPPLY
-  GREEN - POWER SUPPLY
-  WHITE - NO
-  YELLOW - COM

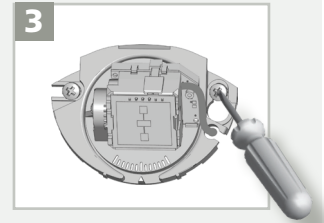

Fix the sensor firmly.

2 FIELD ADJUSTMENTS

SIZE

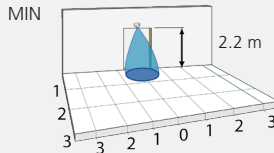

vertical angle: 30°

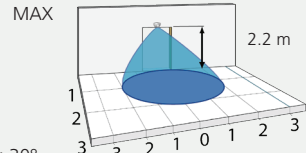

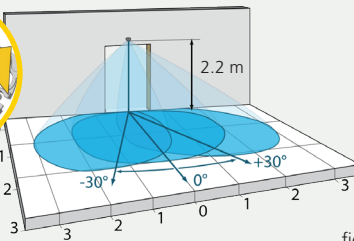
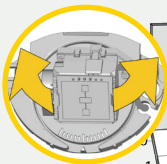

ANGLE

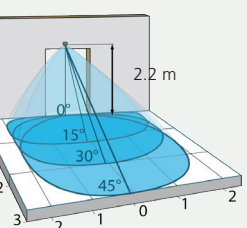
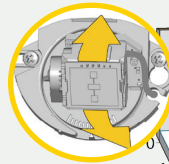

field size: max



TROUBLESHOOTING

	The door remains closed. The LED is OFF.	The sensor power is off.	1 Check the wiring and the power supply.
	The door does not react as expected.	Improper output configuration on the sensor.	1 Change the output configuration setting on each sensor connected to the door operator.
	The door closes and opens constantly.	The sensor is disturbed by the closing of the door or vibrations caused by the door motion.	1 Make sure the sensor is fixed properly. 2 Increase the antenna angle. 3 Reduce the field size.



SAFETY INSTRUCTIONS

The manufacturer of the door system is responsible for carrying out a risk assessment and installing the sensor and the door system in compliance with applicable national and international regulations and standards on door safety and if applicable, the machinery directive 2006/42/EC.

Only trained and qualified personnel may install and setup the sensor.

The warranty is void if unauthorized repairs are made or attempted by unauthorized personnel.

Avoid touching any electronic and optical components.

